

Maintenance:

Typical maintenance of the Solaris is recommended replacement of the SLXMOD module every 36,000 hours approximately 4 years, for optimum results change Module every 2 years.

Replacement Module Part Numbers:

12" replacement module.....SLXMOD

Safety Precautions:

It is recommended that this unit be installed and maintained by a trained technician.

WARNING: UVA Hazard. Always protect eyes from ultraviolet light. NEVER look at UV lamps in operation. Unplug or disconnect power before servicing.

WARNING: Severe eye damage or temporary blindness may occur.

WARNING: DO NOT operate outside of air handler. Mount product in preferred location first.

WARNING: No openings should be allowed which would give direct line-of-sight to the UV light.

Note: In the event of accidental breakage or replacement of the ultraviolet lamp, please ensure that the lamp is disposed of in accordance with local and state environmental laws regarding fluorescent lamps containing mercury.

Notice: All wiring inside of the air handler in direct line of site of the UV lamp must be shielded with aluminum foil tape or equivalent non-combustible material. When installing this unit, select a mounting location that prevents ultraviolet light exposure to synthetic or other plastic components with unknown resistance to ultraviolet light. Ultraviolet light may cause color shift or structural degradation of plastic internal components.

Warranty:

Ultravation® Solaris features Ultravation’s 10 year warranty from date of installation, (minimum expected lifetime of product within normal operating conditions) with the exception of the SLXMOD module, which are warranted for a period of two years after date of installation.

This warranty does not include damage to the unit from accident, misuse or improper installation.

If this product should become defective, Ultravation will elect to repair or replace the product free of charge. Ultravation will return repaired or replaced warranted products pre-paid to the customer, provided that the product was delivered pre-paid. Ultravation shall have no responsibilities for charges incurred by the customer for installation or removal of warranted items. Liability is limited only to the replacement or repair of this product.

This warranty gives you specific legal rights, and you may also have other rights, which vary from state to state. All returns must be accompanied by a return authorization number, which may be obtained by contacting Ultravation, Inc.

Ultravation, Inc.

67 Tubbs Av, Brandon, Vermont 05733
Phone: 1-866-GO-UV-AIR (468-8247) • Fax: 802-287-9203
www.ultravation.com • info@ultravation.com
Copyright © 2008-2025 Ultravation Inc.
DC-OM-SYNSLX REV 4



Ultravation®
SOLARIS®
Air Purifier

Installation and Owners Manual

Model #SLX-LED

Whole House Air purifier with advanced oxidation combined with 8x bi-polar ION generation.

*Operating voltage: 24DC 20 watts.
(24DC 25 VA. Transformer included)*



Activated Carbon / Photocatalytic (PCO) / UVLED / ION Air Purification for HVAC

- 
Eliminates
Odors
- 
Kills
Germs
- 
Allergen
Reduction
- 
Kills Mold
Spores
- 
Removes
Smoke
- 
Patented
Design

Package Contents:

- Solaris LED Module And PCO Reactor
- Four self tapping screws
- Two wire nuts
- 24V Power cord
- 25 VA 24 volt transformer
- Warranty card
- Ductboard plate / sealing tape
- Product gasket

Mechanical installation

1. Determine a location for the Solaris system. Mount the unit on the exit or supply side of the HVAC system and before the ductwork branches off.
2. Separate the power module from the mounting plate.
3. Note the orientation of the power module as it connects in only one direction.
4. Mark a 4.5 - 5" round opening (or use the end of the PCO chamber to mark the area) on the air duct and cut the hole needed for the insertion of the advanced photocatalytic chamber.
5. Thread supplied gasket over PCO module and attach to mounting plate. (Seals against air duct.)
6. Insert the mounting plate / PCO module into opening and attach to duct with two supplied self-tapping screws in the lower left and upper right (only).
7. Place the power module on the unit aligning holes in tabs with holes in mounting plate (upper left /lower right).
8. Secure the power module to the mounting plate with the remaining two self-tapping screws.

Installation procedure for duct board plate

Position duct board plate in the center of the duct board.

Trace and cut or simply cut in the outer slots provided.

Bend mounting tabs inwards being sure they bend at the furthest outside slot.

Now bend inner mounting tabs at the slots provided so they will wrap around the duct board.

The duct board plate is to be used on 1" to 1-1/2" duct board.

Seal edges with provided precut foil back tape.

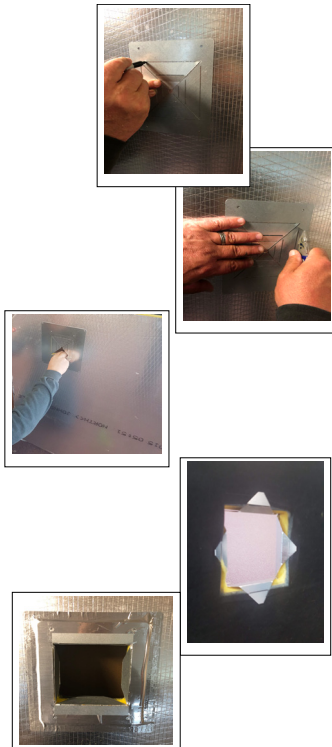

Position
Actuators
Closed

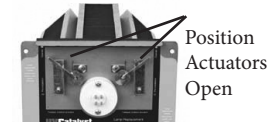

Position
Actuators
Open

The PCO Panels ship in the closed position. Only open for operation after mechanical installation. Never move the panels by hand only use the actuators

Electrical installation

This product operates on 24V and **must** be connected to the supplied power supply.

1. Disconnect power supply before beginning installation to prevent electrical shock or equipment damage.
2. Connect secondary voltage. Refer to voltage color or terminal coding on transformer for proper wire combination.
3. Connect primary voltage. Refer to voltage color coding on transformer for proper wire combination.
4. Tape or protect all unused exposed wire separately to avoid a possible electrical short.
5. Check installation and reconnect power supply for proper operation.
6. Connect 24V wires to supplied 6 ft cable (polarity not important)



Power Supply p/n: AS-IH-4008

Module Replacement Procedure:

The SLXMOD Module is shipped installed in the equipment and should be replaced during biannual service.

To replace the module follow the steps below:

1. Unplug power cord and remove power module cover .
2. Remove used Module (**Caution: Ion pins are sharp**)
3. Install new Module (press into place)
4. Reinstall cover by snapping it into place.
5. Plug power cord in to base of new module, re-apply power.

